

MAIN FLOOR PLAN
1000 SF

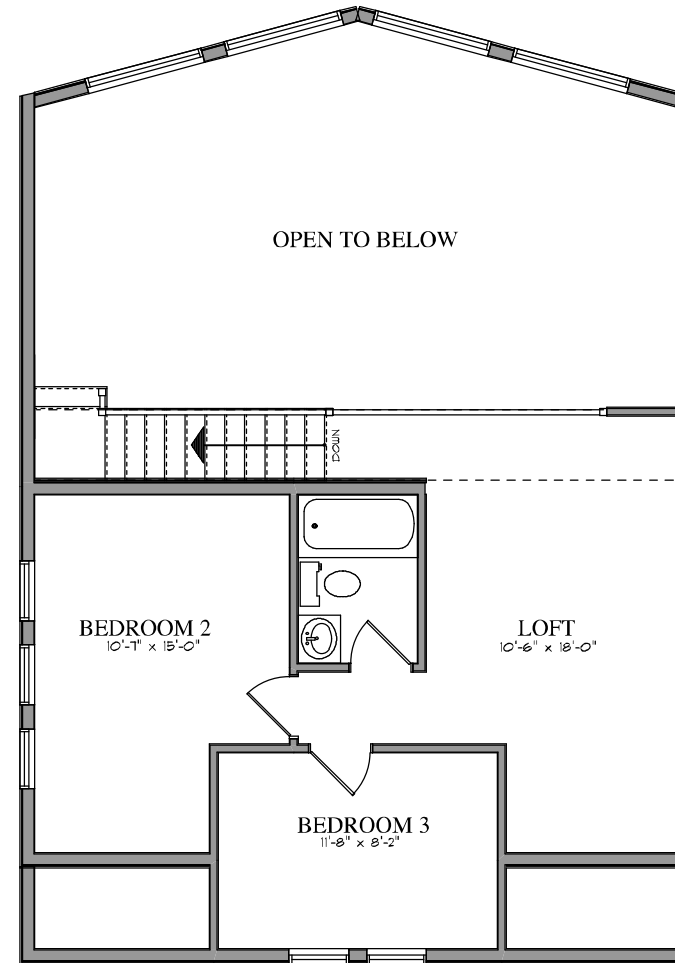

SECOND FLOOR PLAN
540 SF

OVERVIEW
 Main Floor = 1000 sf
 Second Floor = 540 sf
 TOTAL = 1540 sf
 Building Width = 28 ft
 Building Depth = 42 ft

The Coastal by Trafalgar Homes